

# INSTALLATION GUIDE BOSPRAY®

- DIRECT INSTALLATION

## BOWIQ

beyond acoustics

### Europe, Middle East & Asia

**Bowiq Benelux BV**

Hullenbergweg 278

1101 BV Amsterdam

info@bowiq.com

www.bowiq.com

### North America

**Bowiq Nort America LLC**

16192 Coastal Highway, Lewes,

DE 19958, USA

Tel.: +1 302 703 7600

# BOWIQ

beyond acoustics

## Standard fiber colours



Eco-grey



Antraciet



Eco Light-grey



Beige Brook



White



Black

# BOWIQ

beyond acoustics

## Materials

### Bowiq BoSpray – BoFiber White

A Textured Finish

Article code. BF-008150

1 Unit: 1 Bag containing  
**15Kg**

Usage per m<sup>2</sup> at  
**25mm** thickness **9.2m<sup>2</sup>**  
**40mm** thickness **5.7m<sup>2</sup>**

Fiber size

Standard colour White

Shelf life: 12 months



### Bowiq BoSpray – BoFiber Black

A Textured Finish

Article code. BFB

1 Unit: 1 Bag containing  
**12.5Kg**

Usage per m<sup>2</sup> at  
**25mm** thickness **7.6m<sup>2</sup>**  
**40mm** thickness **4.8m<sup>2</sup>**

Fiber size

Standard colour Black

Shelf life: 12 months



# BOWIQ

beyond acoustics

## Bowiq BoSpray – BoFiber Eco Grey

A Textured Finish

Article code. BF-001

1 Unit: 1 Bag containing  
**12.5Kg**

**Usage per m<sup>2</sup> at**  
**25mm thickness** Approx. **7.6m<sup>2</sup>**  
**40mm thickness** **4.8m<sup>2</sup>**

Fiber size

Standard colour Grey

Shelf life: 12 months



## Bowiq BoSpray – BoFiber Eco Light Grey

A Textured Finish

Article code. BFL-001

1 Unit: 1 Bag containing  
**12.5Kg**

**Usage per m<sup>2</sup> at**  
**25mm thickness** Approx. **7.6m<sup>2</sup>**  
**40mm thickness** **4.8m<sup>2</sup>**

Fiber size

Standard colour Light Grey

Shelf life: 12 months



# BOWIQ

beyond acoustics

## Bowiq BoSpray – BoFiber Anthracite

A Textured Finish

Article code. BFA

1 Unit: 1 Bag containing  
**12.5Kg**

**Usage per m<sup>2</sup>** at  
**25mm** thickness Approx. **7.6m<sup>2</sup>**  
**40mm** thickness **4.8m<sup>2</sup>**

Fiber size

Standard colour Extreme Dark Grey

Shelf life: 12 months



## Bowiq BoSpray – BoFiber Beige

A Textured Finish

Article code. BF-010

1 Unit: 1 Bag containing  
**15Kg**

**Usage per m<sup>2</sup>** at  
**25mm** thickness Approx. **9.2m<sup>2</sup>**  
**40mm** thickness **5.7m<sup>2</sup>**

Fiber size

Standard colour Extreme Dark Grey

Shelf life: 12 months



# BOWIQ

beyond acoustics

## Bowiq BoSpray – BoBinder

Article code.	BB-001
1 Unit:	1 drum containing <b>25Kg</b>
Usage per m <sup>2</sup> at <b>25mm thickness</b>	Approx. <b>70m<sup>2</sup></b>
<b>40mm thickness- 2 layers</b>	<b>43m<sup>2</sup></b>
Standard colour	Black
Shelf life:	12 months



## Bowiq BoSpray – Colour Paste

Article code.	
1 Unit:	100-2000G
Usage:	1Kg Paste + 1Kg BoBinder + 8L Water
Bottle size:	1L, 2L & 5L
Shelf life:	6 months



## Tools & Equipment

### Cellulose Spayer Vento RVS

Machine material	Stainless steel
Dimensions	91.5, 67.5,x 11 cm (L x W x H)
Weight	150Kg
Hopper volume	0.2m <sup>3</sup>
Air input	63mm (2 ½“)
Material output dimension	63mm (2 ½“)
Max hose length	50Mtr. 2 ½“ (63mm)
No. airlock chambers	8 pcs

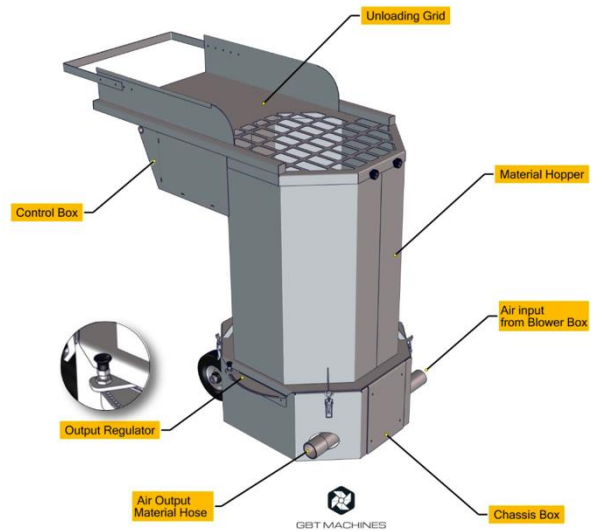

### Glue pump

Machine material	Stainless steel
Dimensions	85, 52,x 50cm (L x W x H)
Weight	60Kg
Max pressure	40 bar
Max output	30L/min



# BOWIQ

beyond acoustics

## Blower

Machine material      Stainless steel

Dimensions              57, 33,x 41 cm  
(L x W x H)

Weight                    26Kg

Max air pressure        300 m bar

Max                        480 m<sup>3</sup>/h

Air exhaust  
connection              63mm (2 ½")

150-300L mixing  
drum                      To mix the BoBinder  
and water

Mixing machine        To mix the BoBinder  
and water

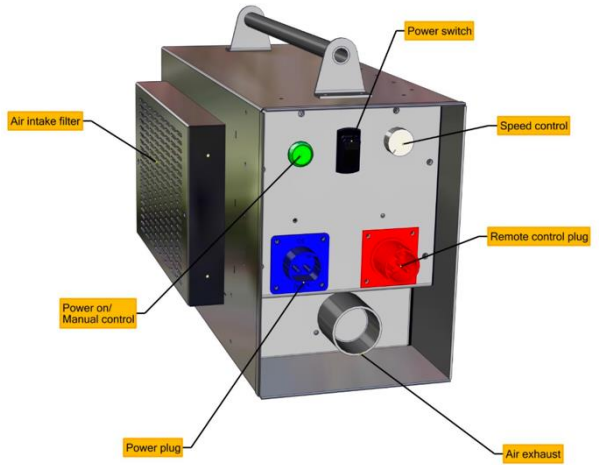

# BOWIQ

beyond acoustics

Knife

To cut open the fiber bag



Plastic covering

To cover walls and MEP's



Grass hand broom

To remove overspray from walls



## Types of installation

### Direct Installation (Type A)

The BoSpray acoustic spray are applied directly onto the substrate

- By priming the substrate with a diluted BoBinder (1:4)
- Spray apply the BoSpray fiber and binder mixture

Test the substrate for bond strength and clean the substrate prior to BoSpray application. It is the installers responsibility to ensure that the substrate is suitable for the use of BoSpray.

The BoSpray is sprayed directly onto a rib deck, concrete substrate or primed plasterboard to a total thickness of 10-40mm. The installer must ensure that any cracks or indents in the substrate has been filled before spraying the plaster.

Suitable substrates:

- Rib deck
- Concrete
- Water resistant or waterproof primed gypsum board
- Previously painted substrates (test before use)

## Installation

Pour BoBinder in a 300L drum

1



Add 250L/ 25kg BoBinder water and mix thoroughly

2



Mix the diluted BoBinder thoroughly

3



Place the glue pump hose in the mixture

4



Switch the glue pump on

5



Set the glue pump to the desired pressure, between 20 and 30 Bar

6



Wear all PPE, dust mask, safety glasses etc.

7



Place the fiber on the unloading grid and start filling the material hopper

8



Turn on the the fiber machine

9



Switch the blower to maximum flow

10



Adjust material control settings according to the fibre type.

11



Open the glue and switch on the fiber blower from the switch connected to the pipe

12



Spray a test piece



13

Check the spray mixture by removing it from the wall/ ceiling



14

Squeeze in your hand, some liquid should come out



15

Spray up and down and side to side



16

## Patching

The BoSpray damage can easily be repaired.

Creating a mixture of the fiber with water and adhesive.

1



2



Use the mixture of fiber, binder and water and patch the damaged area

Lightly tap the surface with a hard hand broom to blend the fibers evenly

3



4



\* Bigger damage can be sprayed over

## Maintenance & Cleaning

### General

BoSpray does not require any maintenance after application.

For cleaning, the surface can be gently cleaned using compressed air and/or a soft brush to remove dust or loose particles.

If required, and where BoSpray has been supplied in a specific colour, a thin refresh coat may be applied over the entire surface using a mixture of the binder, water, and colour paste.

### After Care

BoSpray will cure without interference over a period of two weeks +/- depending on atmospheric conditions. It is advised to ventilate the treated area. No further care is necessary.